

NEW GEN & DUAL LEAD COMPATIBILITY MODIFICATION

READ INSTRUCTIONS COMPLETELY PRIOR TO STARTING

! CONTACT HRF SUPPORT IF YOU EXPERIENCE ISSUES. WARRANTY WILL BE HONORED FOR MODIFIED RAMPS.

OLD GENERATION

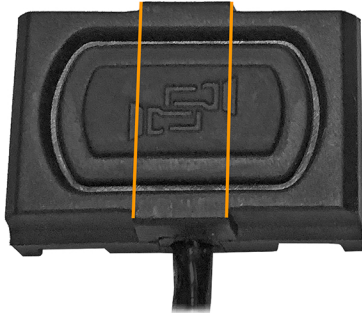

NEW GENERATION

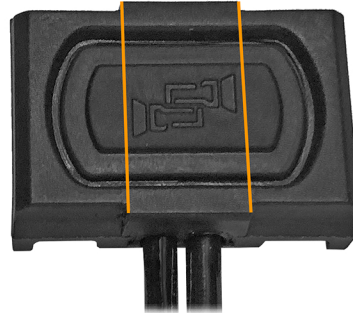

- 1** DETERMINE WHICH GENERATION THE MODBUTTON LITE IS. OLD GENERATION REQUIRES NO MODIFICATION. NEW GENERATION CAN BE IDENTIFIED USING PAPER OR A CARD TO DRAW A LINE FROM EITHER SIDE OF THE MATING TABS. IF THE FLASHLIGHT LOGO IS FULLY VISIBLE IT IS A NEW GENERATION. NOTE: A SINGLE WIRE DOES NOT NECESSARILY MEAN THE MODBUTTON LITE IS AN OLD GENERATION.

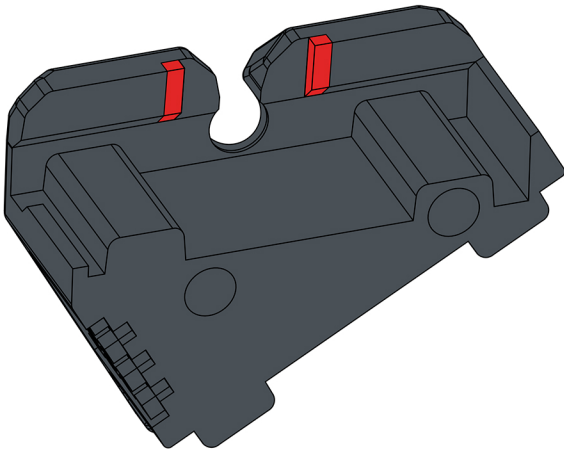

- 2** LOCATING THE MATING TABS ON THE RAMP OR DUAL RAMP PRODUCT AND REMOVE 0.05" (ROUGHLY THE THICKNESS OF A PENNY) OF MATERIAL FROM EACH SIDE AS SHOWN HIGHLIGHTED IN RED. DOUBLE CHECK FITMENT WITH YOUR NEW GENERATION MODBUTTON LITE TO CONFIRM THE AMOUNT OF MATERIAL REMOVED IS CORRECT. THE MODBUTTON LITE TABS SHOULD HAVE A SNUG FIT IN THE RAMP.

- 3** THIS MODIFICATION IS ONLY REQUIRED FOR DUAL LEAD MODBUTTON LITES.

USING A $\frac{5}{32}$ " DRILL BIT, DREMEL BIT OR RAT TAIL FILE, REMOVE MATERIAL LEFT AND RIGHT OF THE EXISTING CABLE CHANNEL AS SHOWN HIGHLIGHTED IN RED. AMOUNT OF MATERIAL REMOVED FROM EACH SIDE IS 0.12" (ROUGHLY THE THICKNESS OF TWO PENNIES). TEST FIT BY GUIDING EACH WIRE SEPARATELY INTO THE NEW CHANNEL AND ENSURE WIRES ARE NOT TIGHT OR SQUISHED TOGETHER.

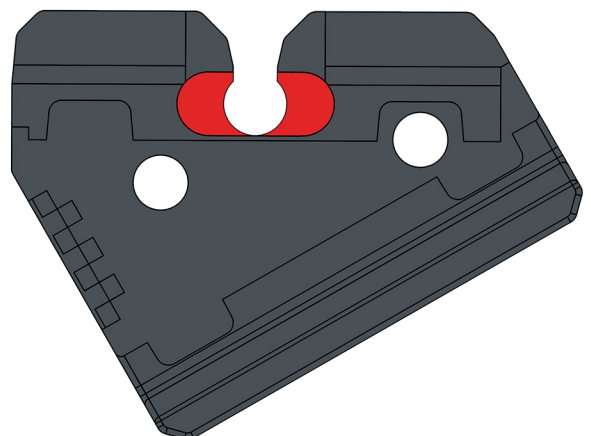

! DO NOT MODIFY MODBUTTON LITE. MODIFY ONLY THE RAMP.